

- NOTES**
- GENERAL**
- DO NOT SCALE FROM THE DRAWING.
 - ALL DIMENSIONS IN METRES UNLESS NOTED OTHERWISE.
 - ALL LEVELS ARE IN METRES ABOVE ORDNANCE DATUM (mAOD).

- LEGEND**
- ORDER LIMITS
 - NEW HIGHWAY BOUNDARY FENCING (MIN 3M FROM E/W TOE)
 - PROPOSED EARTHWORKS
 - PROPOSED CYCLEWAY / FOOTWAY / FOOTPATH ROUTE
 - CARRIAGEWAY
 - PROPOSED BRIDGE
 - PROPOSED RETAINING SOLUTION

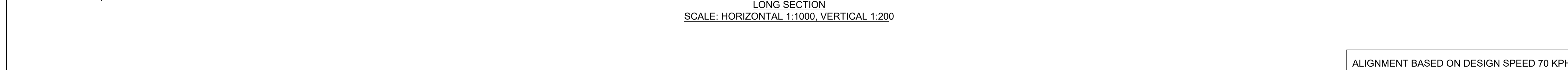
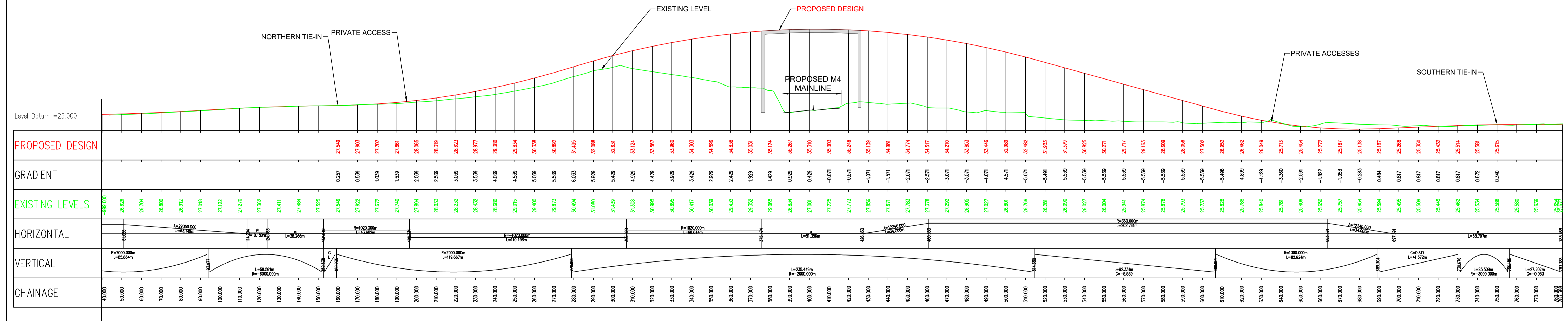
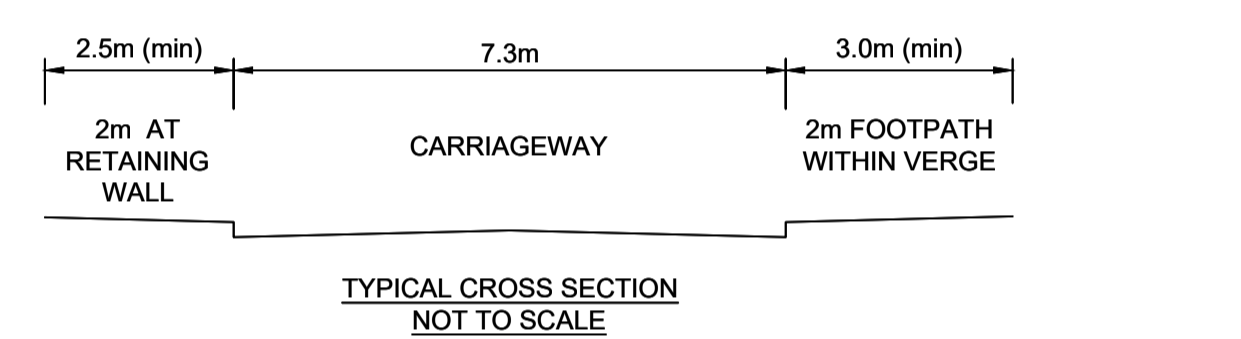

| | | | | | | |
|-----|--------|------------|---------------------------------|-------|-------|---------|
| PO1 | S2 | 18/02/2022 | Non-Material Change Application | WE | ST | DP |
| Rev | Status | Rev. Date | Purpose of revision | Drawn | Chk'd | Apprv'd |

Client: **highways england**

DELIVERING THROUGH **ARCADIS JACOBS**

Project: **SMART MOTORWAYS PROGRAMME M4 JUNCTIONS 3-12**

Drawing title: **SIDE ROAD PLAN & PROFILE REGULATION 4(2) (e) SHEET 1 OF 13 ASCOT ROAD**

| | | | |
|--------------------------------|-------------------|----------------------|------------|
| Status | S2 | Revision | P01 |
| Scale | As Shown | Date | 18/02/2022 |
| Drawn By | William Emery | | |
| Checked By | Stephen Thompson | | |
| Approved By | David Pilsworth | | |
| Project No. | HA PIN | Originator | CHHJ |
| Drawing number | Volume Location | Type Role Number | |
| HSR-S2_LR00000986_Z-DR-CH-0012 | | | |

ALIGNMENT BASED ON DESIGN SPEED 70 KPH